

C	RE-ISSUE FOR DA APPROVAL	JAW			01.11.11
B	ISSUE FOR 60% REVIEW	PNV			
A	ISSUE FOR DA APPROVAL	D.J.G.			
No	Revision	Note: * indicates signatures on original issue of drawing or last revision of drawing	Drawn	Job Manager	Project Director
					Date



GHD CLIENTS | PEOPLE | PERFORMANCE

Levels 2 & 3 GHD Tower, 24 Honeysuckle Drive
Newcastle NSW 2300 Australia
T 61 2 4979 9990 F 61 2 4079 9988
E nrlm@ghd.com W www.ghd.com

DO NOT SCALE

Conditions of Use:
This document may only be used by GHD's client (and any other person who GHD has agreed can use this document) for the purpose for which it was prepared and must not be used by any other person or for any other purpose.

Drawn D.GRIFFIN	Designer J.MAXWELL
Drafting Check J.NEWMCOMBE	Design Check A.SNEDDON
Approved (Project Director) Date	
Scale AS SHOWN	This Drawing must not be used for construction unless signed as Approved

Client Project
**APP CORPORATION
NIER NEW BUILD
STORMWATER LAYOUT PLAN**

Drawing No: **22-15661-C002**

Original Size
A1

Rev: **C**

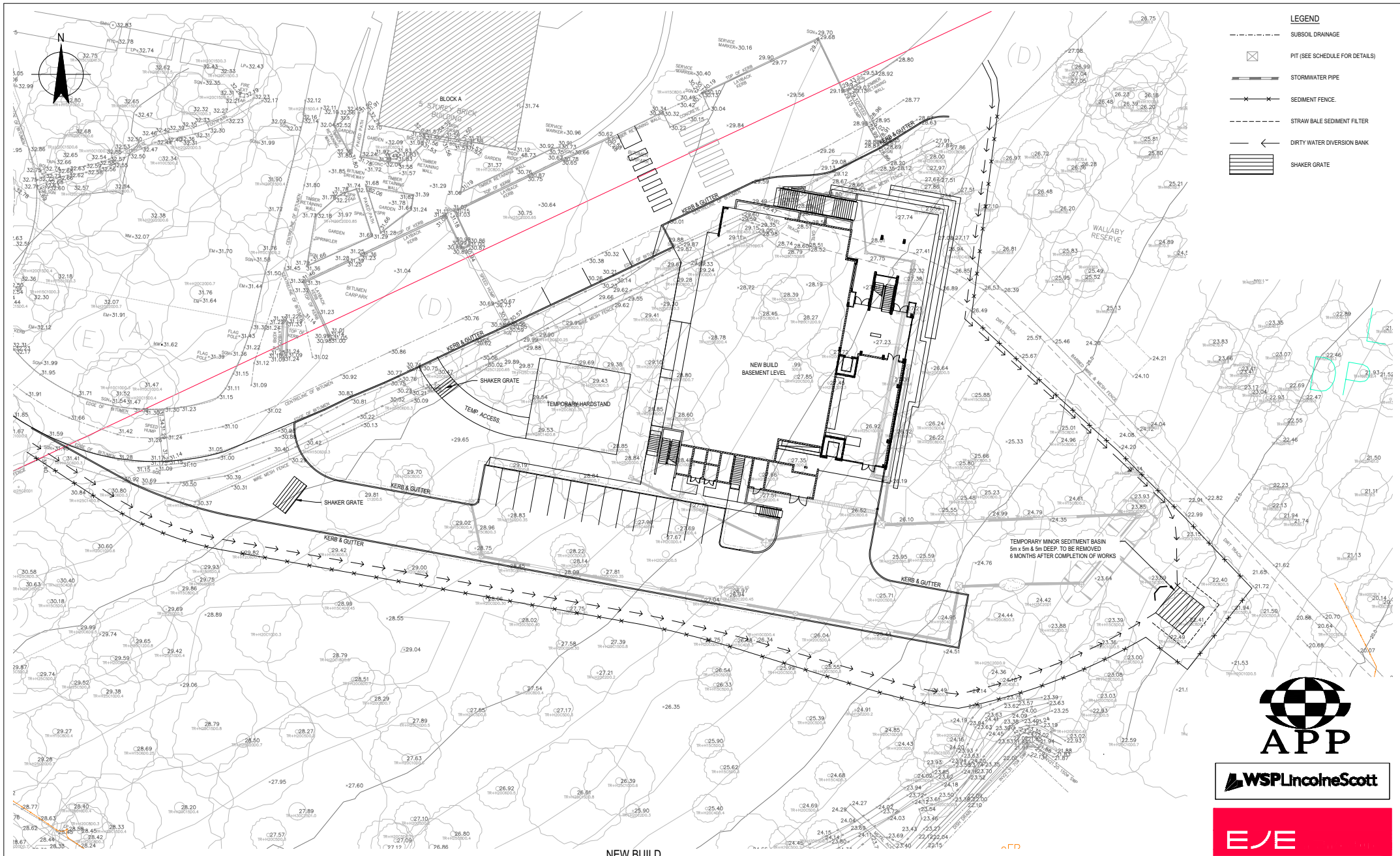

C	RE-ISSUE FOR DA APPROVAL	JAW			01.11.11
B	ISSUE FOR 60% REVIEW	PNV			
A	ISSUE FOR DA APPROVAL	D.J.G.			
No	Revision	Note: * indicates signatures on original issue of drawing or last revision of drawing	Drawn	Job Manager	Project Director



CLIENTS | PEOPLE | PERFORMANCE

Levels 2 & 3 GHD Tower, 24 Honeysuckle Drive
Newcastle NSW 2300 Australia
T 61 2 4979 9990 F 61 2 4979 9988
E nml@ghd.com W www.ghd.com

DO NOT SCALE

Conditions of Use:
This document may only be used by
GHD's client (and any other person who
GHD has agreed can use this document)
for the purpose for which it was prepared
and must not be used by any other
person or for any other purpose.

Drawn D.GRIFFIN

Drafting Check J.NEWMCOMBE

Approved (Project Director)

Date

Scale AS SHOWN

Designer J.MAXWELL

Design Check A.SNEDDON

This Drawing must not be
used for Construction unless
signed as Approved

Client Project

Title

Original Size

A1

APP CORPORATION
NIER NEW BUILD
EROSION & SEDIMENT CONTROL PLAN

Drawing No: **22-15661-C003**

Rev: C



WSPLincolneScott

EJE

PRELIMINARY